

HANOVER
P R O D U C T S

2026 CATALOG

Your On-Premise Promotional Items Resource Guide



VERSION 59

PPAI# 236594

Sage# 27956

ASI# 59535

CHECK OUT OUR NEW PRODUCTS: PG.10

COUNTDOWN TIMER WALL SIGNS

Countdown to your event! Great for St. Patrick's Day, New Year's, Graduation, Cinco De Mayo, The Big Game, Product Launch and all Special Events. Capable of counting down from 999 days. Timer can be used multiple times by simply resetting. Bright 2-inch LED numbers displaying days, hours, minutes and seconds. Includes UL listed wall adapter.



Flip Cover Countdown Timer w/ Changeable Inserts (MLCDT2120)

Marketing material is easily changed via magnetic flip cover. Unit loads from the front allowing you to change your message without removing timer from the wall. Includes one full color insert. Photo quality prints give a professional presentation counting down to new events throughout the year. Manufactured wood product. Additional inserts are available at \$4.00/ea (G).

Product Dimensions: 21" x 20" x 2" | Image Area: 18-3/8" x 12-3/8" | Full Color | Set-up: \$85 (G)
Shipping Box: 23" x 22" x 2" | Shipping Weight: 8 lbs.

Item	1+	5+	10+	25+	50+	100+	250+	500+
MLCDT2120	319.80	287.84	244.61	234.03	209.66	192.60	183.13	178.39 (E)

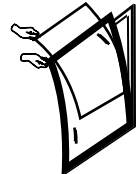

Wood Framed Countdown Timer with Changeable Inserts (CDT2220CI)

Slim LED Illuminated Countdown Timer (ISSCDT1824)

Solid maple wood frame available in black, red mahogany, medium brown or light autumn. Clear acrylic face. Includes one full color insert. Back-loading inserts can be easily changed. Photo quality prints give a professional presentation counting down to new events throughout the year. Additional inserts are available at \$6.00/ea (G).

Acrylic illuminated sign can be contour cut to any shape that fits within the outside dimensions. We can quote any size or shape required for your specific needs.

Product Dimensions: 22" x 20" x 2" | Image Area: 18-7/16" x 11-3/16" | Full Color | Set-up: \$85 (G)
Shipping Box: 24" x 24" x 4" | Shipping Weight: 10 lbs.

Product Dimensions: Up to 18" x 23.5" x .5" | Image Area: Up to 18" x 23.5" | Sides: 1 | Full Color | Set-up: \$156 (Net) | \$5.99 per address drop ship fee | \$.39 per label or sticker fee | Shipping Box: 29.4" x 21.7" x 2.5" | Shipping Weight: 9.8 lbs.

Item	10+	50+	100+	250+	500+
CDT2220CI	277.69	265.16	249.99	239.71	227.03 (E)
ISSCDT1824	302.59	265.89	248.96	235.64	228.90 (E)



Countdown Timer Sign (CDT1824)

Chalkboard Countdown Timer Sign* (CDT1824CB)

Dry Erase Countdown Timer Sign* (CDT1824DE)

Permanent branding and messaging for annual event or also available as either a chalkboard or dry erase writing surface with permanent branding giving ability to change message throughout the year. Manufactured wood product with direct printed high resolution graphic. *Chalk or marker included.

Product Dimensions: 18" x 23.5" x 2" | Image Area: 18" x 23.5" | Full Color | Set-up: \$85 (G)
Shipping Box: 27" x 20" x 2" | Shipping Weight: 6.6 lbs.

Item	10+	50+	100+	250+	500+
CDT1824	209.20	183.60	166.74	157.47	152.94 (E)
CDT1824CB	215.80	186.57	168.01	157.76	152.9 (E)
CDT1824DE	215.80	186.57	168.01	157.76	152.91 (E)



Born on Date Timer Sign (BDT1824)

Slim LED Illuminated Born on Date Timer Sign w/ Clock (ISSBDT1824CL)

Timer displays "Must Be Born Before" date. Set once and timer will automatically update. Bright LED numbers displaying month, day and year. Includes UL listed wall adaptor. Manufactured wood or acrylic product with direct printed high resolution graphic.

Product Dimensions: 18" x 23.5" x 2" | Image Area: 18" x 23.5" | Full Color | Set-up: \$85 (G)
Shipping Box: 27" x 20" x 2" | Shipping Weight: 6.6 lbs.

Item	10+	50+	100+	250+	500+
BDT1824	169.89	150.14	137.13	129.99	126.50 (E)
BDTDC1824IL	346.57	304.73	280.46	260.86	250.44 (E)



SIGNS

SPECIALTIES

CLOCKS

MIRRORS

SPECIALTY CLOCKS

ILLUMINATED CLOCKS

Versatile signs to promote your brand while highlighting daily specials, menu items, upcoming events, etc. Can be used on sidewalks, entrances, lobbies, and for special events. All A-frames are two-sided and suitable for indoor and outdoor use.

SIGNS

SPECIALTIES

CLOCKS

MIRRORS

SPECIALTY CLOCKS

ILLUMINATED CLOCKS



Chalkboard Dimensional A-frame Sidewalk Sign (AFD2839CB)

Dry Erase Dimensional A-frame Sidewalk Sign (AFD2839DE)

All graphics are direct printed on the frame which is raised and stands out from the writing surface. The frame is custom shaped to fit your image/brand. Writing surface can be chalkboard or dry erase. Marker or chalk is included. Moisture resistant manufactured wood product.

Product Dimensions: 28" x 39" | Image Area: 28" x 39" | Sides: 2 | Full Color | Set-up: \$195 (G)
Shipping Box: 43" x 31" x 2" | Shipping Weight: 23 lbs.

Item	10+	50+	100+	250+	500+	
AFD2839CB	330.72	304.80	281.42	265.68	249.58	(D)
AFD2839DE	330.72	304.80	281.42	265.68	249.58	(D)



Chalkboard Flat A-frame Sidewalk Sign (AFF2439CB)

Dry Erase Flat A-frame Sidewalk Sign (AFF2439DE)

A-frame is custom shaped to fit your image/brand/logo. Writing surface can be chalkboard or dry erase. Marker or chalk is included. Direct printed on moisture resistant manufactured wood.

Product Dimensions: 23.5" x 39" | Image Area: 23.5" x 39" | Sides: 2 | Full Color | Set-up: \$195 (G)
Shipping Box: 43" x 27" x 2" | Shipping Weight: 24.5 lbs.

Item	10+	50+	100+	250+	500+	
AFF2439CB	231.08	207.65	192.77	185.98	182.31	(D)
AFF2439DE	231.08	207.65	192.77	185.98	182.31	(D)



Solid Wood A-frame Sidewalk Sign (AFWK2439CB) & (AFW5H2536CB-RM)

Solid wood a-frame painted black. High resolution graphic is direct printed on chalkboard panel. Chalk is included.

Product Dimensions: 23.5" x 39" | Image Area: 19.5" x 33" | Sides: 2 | Full Color | Set-up: \$85 (G)
Shipping Box: 43" x 27" x 2" | Shipping Weight: 20 lbs (AFWK2439CB)

Solid wood a-frame painted black. Full-color high-resolution graphic is direct printed on removable chalkboard panel. One color white logo printed on header. Chalk is included.

Product Dimensions: 25" x 36" | Chalkboard Image Area: 23" x 28" | Header Image Area: 4.25 x 23 | Sides: 2 | Full Color
Set-up: \$85 (G) | Shipping Box: 43" x 27" x 2" | Shipping Weight: 20 lbs (AFW5H2536CB-RM)

Item	10+	50+	100+	250+	500+	
AFWK2439CB	226.22	203.23	186.89	177.88	173.22	(D)
AFW5H2536CB-RM	324.49	307.46	294.92	278.98	262.49	(D)



Chalkboard Rustic Real Wood A-frame Sidewalk Sign (AFR2439CB)

Solid ash frame with weathered/rustic finish. High resolution graphic is direct printed on chalkboard panel. Chalk is included.

Product Dimensions: 23.5" x 39" | Image Area: 19.5" x 33" | Sides: 2 | Full Color | Set-up: \$85 (G)
Shipping Box: 43" x 27" x 2" | Shipping Weight: 23 lbs.

Item	10+	50+	100+	250+	500+	
AFR2439CB	224.94	199.58	182.32	172.77	168.08	(D)



Dry Erase Metal A-frame Sidewalk Sign (AFM2439DE)

All graphics are direct printed on the inserts. The frame is metal, extruded with a channel and powder coated. Custom graphics can be printed in full color process on the inserts before the dry erase coating is applied to protect the image. Marker is included.

Product Dimensions: 24" x 39" | Image Area: 24" x 36" | Sides: 2 | Full Color | Set-up: \$85 (G)

Item	10+	50+	100+	250+	500+	
AFM2439DE	490.51	434.77	401.82	374.69	360.02	(D)

ILLUMINATED SIGNS

Slim LED Illuminated Dry Erase Board 18" x 24" (IDE1824)

Light up your brand with bright and bold illuminated dry erase board. Includes impressive full color high resolution imprint. Acrylic illuminated board can be contour cut to any shape that fits within the outside dimensions. We can quote any size or shape required for your specific needs. Includes a four pack of fluorescent wet erase markers that glow when used on the board. LED illumination is powered by UL listed power supply with integrated on/off switch. Made in the U.S.A. Concept through production completed domestically in days without the hassle and time of overseas production.



Product Dimensions: Up to 18" x 23.5" x .5" | Image Area: Up to 18" x 23.5" | Sides: 1 | Full Color | Set-up: \$195 (G)
Shipping Box: 29.4" x 21.7" x 2.5" | Shipping Weight: 9.5 lbs.

Item	10+	50+	100+	250+	500+	
IDE1824	181.73	161.11	141.03	129.17	120.21	(D)

Illuminated Daily Specials Dry Erase Board Sign 24" x 36" (IDE2436DS)

Light up your brand with bright and bold illuminated dry erase board. Includes impressive full color high resolution imprint. Acrylic illuminated board can be contour cut to any shape that fits within the outside dimensions. We can quote any size or shape required for your specific needs. Includes a four pack of fluorescent wet erase markers that glow when used on the board. LED illumination is powered by UL listed power supply with integrated on/off switch. Made in the U.S.A. Concept through production completed domestically in days without the hassle and time of overseas production.

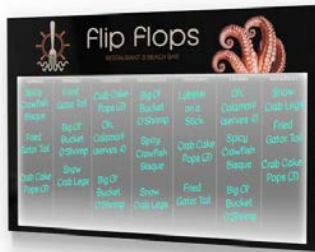

Product Dimensions: Up to 23.5" x 35" x .5" | Image Area: Up to 23.5" x 35" | Sides: 1 | Full Color | Set-up: \$156 (Net) | \$5.99 per address drop ship fee | \$.39 per label or sticker fee | Shipping Box: 38.5" x 26.5" x 2.8" | Shipping Weight: 19 lbs.

Item	10+	50+	100+	250+	500+	
IDE2436DS	307.47	278.60	254.59	226.37	209.87	(E)

Backlit Illuminated Chalkboard 14" x 22" (CB1422i)

Solid maple wood frame available in black, red mahogany, medium brown or light autumn. High resolution graphics are backlit. LED illumination is powered by UL listed power supply with integrated on/off switch.



Product Dimensions: 22" x 14" x 3.5" | Image area: 20.5" x 12.5" | Sides: 1 | Full Color
Set-up: \$195 (G) | Shipping Box: 24.5" x 15.75" x 4.25" | Shipping Weight: 8 lbs.

Item	10+	50+	100+	250+	500+	
CB1422i	156.99	143.71	132.67	127.33	123.39	(E)

WOODEN KEY CADDY

Permanently branded key holder with the ability to update message. Holds up to 6 keys. Features compartment to hold mail, magazines, documents, etc. Full color imprint. Chalk/ Dry Erase Marker included.

Key Caddy Chalkboard 12" x 16" (KEY1216CB)

Key Caddy Dry Erase 12" x 16" (KEY1216DE)

Direct printed .5" thick manufactured wood.



Product Dimensions: 12" x 16" x 3" | Image Area: 12" x 5" | Sides: 1 | Full Color | Set-up: \$195 (G)
Shipping Box: 20.8" x 14.5" x 5" | Shipping Weight: 3 lbs.

Item	10+	50+	100+	250+	500+	
KEY1216CB	102.68	85.92	75.98	70.52	68.09	(D)
KEY1216DE	102.68	85.92	75.98	70.52	68.09	(D)

Light up your brand with bright and bold illuminated signs. Includes impressive full color high resolution imprint. Acrylic illuminated sign can be contour cut to any shape that fits within the outside dimensions. We can quote any size or shape required for your specific needs. LED illumination is powered by UL listed power supply with integrated on/off switch. Made in the U.S.A. Concept through production completed domestically in days without the hassle and time of overseas production.



Slim LED Illuminated Sign 18" x 24" (ISS1824)

Product Dimensions: Up to 18" x 23.5" x .5" | Image Area: Up to 18" x 23.5" | Sides: 1
Full Color | Set-up: \$195 (G) | Shipping Box: 29.4" x 21.7" x 2.5" | Shipping Weight: 9.5 lbs.



Slim LED Illuminated Sign 24" x 24" (ISS2424)

Product Dimensions: Up to 23.5" x 23.5" x .5" | Image Area: Up to 23.5" x 23.5" | Sides: 1
Full Color | Set-up: \$195 (G) | Shipping Box: 29" x 28" x 4.25" | Shipping Weight: 13 lbs.



Slim LED Illuminated Sign 24" x 36" (ISS2436)

Product Dimensions: Up to 23.5" x 35" x .5" | Image Area: Up to 23.5" x 35" | Sides: 1
Full Color | Set-up: \$195 (G) | Shipping Box: 38.5" x 26.5" x 2.8" | Shipping Weight: 19 lbs.

Slim LED Illuminated 16" Diameter (ISSC16)

Product Dimensions: Up to 15.75" diameter x .5" | Image Area: Up to 14.5" diameter | Sides: 1
Full Color | Set-up: \$85 (G) | Shipping Box: 23.4" x 22.2" x 2.5" | Shipping Weight: 8 lbs.

Item	10+	50+	100+	250+	500+	
ISS1824	203.43	168.77	153.19	141.26	135.17	(E)
ISS2424	236.00	197.01	179.43	165.77	158.76	(E)
ISS2436	353.47	298.87	274.03	254.21	243.77	(E)
ISSC16	153.84	125.79	113.29	103.93	99.29	(E)



Slim LED Illuminated Sign 18" x 24" w/Floating Panel (ISSFP1824)

Front panel is separated from the back with stand-offs providing dimension that make your brand pop.

Product Dimensions: Up to 18" x 23.5" x .1" | Image Area: Up to 18" x 23.5" | Sides: 1 | Full Color
Set-up: \$195 (G) | Shipping Box: 29.4" x 21.7" x 2.5" | Shipping Weight: 9.5 lbs.

Item	10+	50+	100+	250+	500+	
ISSFP1824	256.07	220.20	205.37	192.77	182.54	(E)



Slim LED Illuminated Sign 18" x 24" w/Raised Panel (ISSRP1824)

Raised panels are attached to the front panel providing dimension that make your brand pop.

Product Dimensions: Up to 18" x 23.5" x .1" | Image Area: Up to 18" x 23.5" | Sides: 1 | Full Color
Set-up: \$195 (G) | Shipping Box: 29.4" x 21.7" x 2.5" | Shipping Weight: 9.5 lbs.

Item	10+	50+	100+	250+	500+	
ISSRP1824	254.64	224.84	210.09	194.30	184.34	(E)

SIGNS

SPECIALTIES

CLOCKS

MIRRORS

SPECIALTY CLOCKS

ILLUMINATED CLOCKS

MANUFACTURED WOOD SIGNS

Custom shape wooden wall signs are direct printed on .375" thick manufactured wood. Ready to hang with sawtooth hanger. Signs can be contour cut to any shape that fits within the outside dimensions.



Wood Sign 18" x 24" (WS1824)

Product Dimensions: Up to 18" x 23.5" x .375" | Image Area: Up to 18" x 23.5" | Sides: 1
Full Color | Set-up: \$195 (G) | Shipping Box: 29.75" x 18.125" x 1" | Shipping Weight: 6.0 lbs.

Wood Sign 24" x 24" (WS2424)

Product Dimensions: Up to 23.5" x 23.5" x .375" | Image Area: Up to 23.5" x 23.5" | Sides: 1
Full Color | Set-up: \$195 (G) | Shipping Box: 26.3" x 32" x 1" | Shipping Weight: 8.4 lbs.

Wood Sign 24" x 36" (WS2436)

Product Dimensions: Up to 23.5" x 35" x .375" | Image Area: Up to 23.5" x 35" | Sides: 1
Full Color | Set-up: \$195 (G) | Shipping Box: 26" x 38" x 1" | Shipping Weight: 13.4 lbs.

Item	10+	50+	100+	250+	500+	
WS1824	72.77	57.88	50.49	45.28	42.94	(D)
WS2424	86.38	70.68	62.55	56.82	54.05	(D)
WS2436	112.54	94.02	84.18	77.03	73.49	(D)

WOOD BARREL WALL SIGNS

Replica barrel top sign constructed with real wood. High resolution graphic direct printed on stained birch chalkboard or mirror. Chalkboard sign includes chalk.



Wood Barrel Printed Wall Sign 20" (BSP20)

Wood Barrel Chalkboard Wall Sign 20" (BSCB20)

Barrel Acrylic Mirror Wall Sign 20" (BSP20MRA)

Product Dimensions: Up to 20" x 20" x 3.5" | Image Area: Up to 17" diameter | Sides: 1 | Full Color
Set-up: \$195 (G) | Shipping Box: 24" x 4.25" x 24" | Shipping Weight: 6 lbs.

Item	10+	50+	100+	250+	500+	
BSP20	199.89	182.74	169.40	159.34	147.03	(D)
BSCB20	210.68	189.83	174.60	163.38	150.60	(D)
BSP20MRA	226.54	215.20	203.68	194.05	179.86	(D)



Barrel Top Sign 20" w/Analog Clock (BSP20CL)

Product Dimensions: 20" x 20" x 3.5" | Image Area: Up to 17" diameter | Sides: 1 | Full Color
Set-up: \$196 (G) | Shipping Box: 24" x 4.25" x 24" | Shipping Weight: 10 lbs.

Item	10+	50+	100+	250+	500+	
BSP20CL	224.23	211.86	199.91	190.14	176.11	(D)

SIGNS

SPECIALTIES

CLOCKS

MIRRORS

SPECIALTY CLOCKS

ILLUMINATED CLOCKS

CUSTOM CHALKBOARD/DRY ERASE SIGNS

Permanently branded signs with the ability to update message. Full color imprint. Chalk or marker included. Great for restaurants, bars, banks, hotels, schools, dealerships, office and retail.



Custom Chalkboard 12" x 16" (CB1216) or Dry Erase 12" x 16" (DE1216) 🌱

Predrilled hole for hanging. Direct printed .125" thick manufactured wood.

Product Dimensions: 12" x 16" x .125" | Image Area: 12" x 16" | Sides: 1 | Full Color | Set-up: \$85 (G)
Shipping Box: 20.125" x 18.25" x .375" | Shipping Weight: 1 lbs.

Custom Chalkboard 18" x 24" (CB1824) or Dry Erase 18" x 24" (DE1824) 🌱

Direct printed .375" thick manufactured wood. Comes ready to hang with sawtooth hanger.

Product Dimensions: 18" x 23.5" x .375" | Image Area: 18" x 23.5" | Sides: 1 | Full Color | Set-up: \$85 (G)
Shipping Box: 30" x 22" x 2" | Shipping Weight: 8 lbs.

Custom Chalkboard 24" x 36" (CB2436) or Dry Erase 24" x 36" (DE2436) 🌱

Direct printed .375" thick manufactured wood. Comes ready to hang with sawtooth hanger.

Product Dimensions: 23.5" x 35" x .375" | Image Area: 23.5" x 35" | Sides: 1 | Full Color | Set-up: \$85 (G)
Shipping Box: 38" x 27" x 3" | Shipping Weight: 14 lbs.

Item	10+	50+	100+	250+	500+	
CB1216	41.68	35.62	29.20	25.17	23.52	(D)
DE1216	41.68	35.62	29.20	25.17	23.52	(D)
CB1824	78.12	67.72	57.78	51.12	48.26	(D)
DE1824	78.12	67.72	57.78	51.12	48.26	(D)
CB2436	121.83	107.02	94.57	85.68	81.54	(D)
DE2436	121.83	107.02	94.57	85.68	81.54	(D)

WOOD FRAMED CHALKBOARD/DRY ERASE SIGNS

Solid maple wood frame available in black, red mahogany, medium brown or light autumn. Chalk or marker included. High resolution graphic direct printed on dry erase/chalkboard.



Wood Framed Chalkboard 12" x 16" (CB1216F) or Dry Erase 12" x 16" (DE1216F) 🌱

Product Dimensions: 12" x 16" x .68" | Image Area: 12" x 16" | Sides: 1 | Full Color | Set-up: \$85 (G)
Shipping Box: 17.75" x 17.75" x 4.25" | Shipping Weight: 3 lbs.

Wood Framed Chalkboard 18" x 24" (CB1824F) or Dry Erase 18" x 24" (DE1824F) 🌱

Product Dimensions: 18" x 23.5" x .375" | Image Area: 18" x 23.5" | Sides: 1 | Full Color | Set-up: \$85 (G)
Shipping Box: 30" x 22" x 2" | Shipping Weight: 8 lbs.

Wood Framed Chalkboard 24" x 36" (CB2436F) or Dry Erase 24" x 36" (DE2436F) 🌱

Product Dimensions: 23.375" x 35.375" x .68" | Image Area: 21" x 33" | Sides: 1 | Full Color | Set-up: \$85 (G)
Shipping Box: 38" x 27" x 3" | Shipping Weight: 11 lbs. Shipping Box: 38" x 27" x 3" | Shipping Weight: 14 lbs.

Item	10+	50+	100+	250+	500+	
CB1216F	96.66	86.55	75.32	68.17	64.11	(D)
DE1216F	96.66	86.55	75.32	68.17	64.11	(D)
CB1824F	124.20	109.45	96.00	87.20	82.20	(D)
DE1824F	124.20	109.45	96.00	87.20	82.20	(D)
CB2436F	184.91	166.86	150.63	139.15	132.25	(D)
DE2436F	184.91	166.86	150.63	139.15	132.25	(D)

*Custom color painted frame available for an additional fee.

RUSTIC WOOD FRAMED CHALKBOARD SIGNS

Permanently branded signs with the ability to update message. Chalk included. Ready to hang. Features a solid ash frame with weathered/rustic finish. High resolution graphic direct printed on chalkboard.



Rustic Wood Framed Chalkboard 18" x 24" (CB1824RF) 🌱

Product Dimensions: 18.875" x 23.375" x .68" | Image Area: 16" x 20.5" | Sides: 1 | Full Color | Set-up: \$85 (G)
Shipping Box: 30" x 22" x 3" | Shipping Weight: 7 lbs.

Rustic Wood Framed Chalkboard 24" x 36" (CB2436RF) 🌱

Product Dimensions: 23.375" x 35.375" x .68" | Image Area: 16" x 20.5" | Sides: 1 | Full Color | Set-up: \$85 (G)
Shipping Box: 38" x 27" x 3" | Shipping Weight: 11 lbs.

Item	10+	50+	100+	250+	500+	
CB1824RF	135.65	120.74	106.66	97.42	91.60	(D)
CB2436RF	201.68	180.91	162.65	150.00	141.97	(D)

CORNHOLE GAMES

Popular bean bag game. Also known as corn toss, bean bag toss or bags. Great for restaurants, bars, tailgates and events. Legs fold in for easy transport. Manufactured moisture resistant wood product with direct printed high resolution graphics. Each set includes 2 game boards and 8 bean bags. Bags available in red, blue, black and yellow.



Cornhole Pro 24" x 48" (CTP)

Traditional full size boards.

Product Dimensions: 24" x 48" | Image Area: 24" x 48" | Sides: 1 | Full Color | Set-up: \$85 (G)
Shipping Box: 51" x 27" x 4" | Shipping Weight: 53 lbs.

Item	5+	10+	25+	50+	100+	
CTP	349.19	309.51	284.50	273.40	261.80	(E)



Custom Shape Cornhole Pro 24" x 48" (CTPCS)

Same as Pro size with custom shape.

Product Dimensions: Up to 24" x 48" | Image Area: Up to 24" x 48" | Sides: 1 | Full Color | Set-up: \$195 (G)
Shipping Box: 51" x 27" x 4" | Shipping Weight: 53 lbs.

Item	5+	10+	25+	50+	100+	
CTPCS	394.47	328.84	294.86	276.89	266.36	(E)



Cornhole Sport 24" x 36" (CTS)

Same quality as the traditional size. More convenient size/weight for travel and storage.

Product Dimensions: 24" x 35" | Image Area: 24" x 35" | Sides: 1 | Full Color | Set-up: \$85 (G)
Shipping Box: 38" x 27" x 4" | Shipping Weight: 39.5 lbs.

Item	5+	10+	25+	50+	100+	
CTS	307.87	254.43	228.20	214.79	207.10	(E)



Custom Shape Cornhole Sport 24" x 36" (CTSCS)

Same as Sport size with custom shape. More convenient size/weight for travel and storage.

Product Dimensions: Up to 24" x 35" | Image Area: Up to 24" x 35" | Sides: 1 | Full Color | Set-up: \$195 (G)
Shipping Box: 38" x 27" x 4" | Shipping Weight: 39.5 lbs.

Item	5+	10+	25+	50+	100+	
CTSCS	342.81	281.99	251.36	235.27	225.99	(E)



*Custom 1 Color or 4 color imprinted bags available upon request.

ALUMINUM METAL TACKER SIGNS

Perfect for either contemporary or nostalgic wall signs. Custom shape signs constructed with .024" thick aluminum. Aluminum is an ideal substrate for indoor/outdoor use that will not rust. Full color printing included at no additional cost. Comes ready to hang with predrilled holes. Signs can be contour cut to any shape that fits within the outside dimensions. Can be embossed for additional set-up of \$95 (G) with no add'l run charge.



Aluminum Sign 18" x 24" (AS1824)

Product Dimensions: Up to 17.5" x 23.5" x .024" | Image Area: Up to 17.5" x 23.5" | Sides: 1
Full Color | Set-up: \$195 (G) | Shipping Box: 29.75" x 18.125" x .5" | Shipping Weight: 2.3 lbs

Aluminum Sign 24" x 24" (AS2424)

Product Dimensions: Up to 23.5" x 23.5" x .024" | Image Area: Up to 23.5" x 23.5" | Sides: 1
Full Color | Set-up: \$195 (G) | Shipping Box: 26.3" x 32" x .5" | Shipping Weight: 3.4 lbs.

Aluminum Sign 24" x 36" (AS2436)

Product Dimensions: Up to 23.5" x 35" x .024" | Image Area: Up to 23.5" x 35" | Sides: 1
Full Color | Set-up: \$195 (G) | Shipping Box: 26" x 38" x .5" | Shipping Weight: 5.9 lbs.

Item	10+	50+	100+	250+	500+	
AS1824	44.77	36.49	31.75	29.15	28.03	(D)
AS2424	78.02	65.63	58.17	54.09	52.26	(D)
AS2436	89.11	76.75	69.02	64.78	62.75	(D)

SIGNS

SPECIALTIES

CLOCKS

MIRRORS

SPECIALTY CLOCKS

ILLUMINATED CLOCKS

Constructed with solid maple. Available in red mahogany, medium brown or light autumn. Logo is laser engraved on up to three sides.



Bar Caddy (BCW0610)

Holds napkins, straws, stirrers, utensils, etc. Price includes laser engraving on up to three sides. Product Dimensions: 10" x 6.25" x 4.25" | Image Area: 2.75" x 2.75" | Sides: 4 (3 engraved) | Set-up: \$85 (G) Shipping Box: 10.75" x 7.25" x 5.25" | Shipping Weight: 2.6 lbs.

Napkin Holder (NHW0606)

Holds napkins up to 5.5" x 5.5". Price includes laser engraving on up to three sides. Product Dimensions: 6" x 6" x 4.25" | Image Area: 2.75" x 2.75" | Sides: 4 (3 engraved) | Set-up: \$85 (G) Shipping Box: 9.25" x 8.75" x 7.25" | Shipping Weight: 2.2 lbs.

Coaster Holder (CHW0404)

Holds coaster up to 4" x 4". Price includes laser engraving on up to three sides. Product Dimensions: 4.25" x 4.25" x 4.25" | Image Area: 2.75" x 2.75" | Sides: 4 (3 engraved) | Set-up: \$85 (G) Shipping Box: 9.25" x 8.75" x 7.25" | Shipping Weight: 2 lbs.

Wood Condiment Caddy (CCW0608)

Constructed with solid Poplar. Available in red mahogany, medium brown or light autumn. Logo is laser engraved on two sides. Price includes laser engraving on two sides. Product Dimensions: 8.125" x 6.125" x 9" | Image Area: 2.75" x .75" | Sides: 4 (2 engraved) | Set-up: \$85 (G) | Shipping Box: 22" x 10" x 10" (4/Pk) | Shipping Weight: 2.6 lbs

Wood Condiment Caddy w/ Bottle Opener (CCW1006)

Constructed with solid Poplar. Available in red mahogany, medium brown or light autumn. Includes bottle opener mounted on one end. Price includes laser engraving on two sides. Made in the USA Product Dimensions: 11.8" x 5.625" x 10" | Image Area: 10.625" x 75" | Sides: 2 | Colors: 1 | Set-up: \$85 (G)

Item	10+	50+	100+	250+	500+	
BCW0610	91.55	87.77	82.95	79.71	75.55	(D)
NHW0606	70.37	62.85	57.17	53.63	51.82	(D)
CHW0404	57.46	55.14	52.06	49.98	47.35	(D)
CCW0608	87.77	80.98	75.98	72.49	69.02	(D)
CCW1006	86.97	73.49	66.23	60.80	58.11	(D)

CHANGEABLE ITEMS

Units are permanently branded and allow end user to change messaging with printed inserts or bottle. Great for restaurants, bars, hotels, schools, dealerships and retail.



Small/Large Wood Chalkboard Holder (IHW0406CB) (IHW8511CB)

Units are permanently branded and allow end user to change messaging on chalkboard.. Great for restaurants, bars, banks, hotels, schools, dealerships and retail. Constructed with solid maple. Available in red mahogany, medium brown, light autumn or black. One color logo included. Bulk packed.

Product Dimensions: Approx. 4" x 7" x 2" (Insert 4" x 6") | Image Area On Base: 3.5"x 0.75" | Colors: 1 | Sides: 2 | Set-up: \$85 (G)
 Product Dimensions: Approx. 8.5" x 11" x 2" (Insert 8.5" x 11") | Image Area On Base: 8.5"x 0.75" | Colors: 1 | Sides: 2 | Set-up: \$85 (G)

Item	50+	100+	250+	500+
IHW0406CB	16.65	12.66	10.51	9.45 (D)
IHW8511CB	41.42	33.28	28.78	26.26 (D)



Small/Large Acrylic Insert Holder (IHA0406) (IHA8511)

Constructed with .090" acrylic. Accepts 8.5" x 11" or 4" x 6" paper inserts (not included). Inserts can be loaded from the top or sides. Base of the holder is white and includes full color imprint. Bulk packed.

Product Dimensions: 8.5" x 12.5" x 3.125" | Image Area - Base: 8" x 1.75" | Sides: 2 | Full Color (white bkgd) | Set-up: \$85 (G)
 Product Dimensions: 4.5" x 7.5" x 2" | Image Area On Base: 4" x 1.5" | Sides: 2 | Full Color (white bkgd) | Set-up: \$85 (G)

Item	50+	100+	250+	500+
IHA0406	18.08	13.06	10.34	9.38 (D)
IHA8511	36.03	28.11	23.58	21.85 (D)



Bottle Shaped Acrylic Insert Holder (BTS0508)

Each unit is permanently branded and allows end user to change messaging with printed inserts. Print your own inserts with any color printer. Great for restaurants, bars, banks, hotels, schools, dealerships and retail. Constructed with .125" acrylic. Accepts 4" x 6" paper inserts (not included). Inserts can be attached to binder clips by using a standard paper hole punch. Bulk packed.

Product Dimensions: 5" x 8" x 2.75" | Sides: 2 | Full Color | Set-up: \$85 (G)

Item	10+	50+	100+	250+	500+
BTS0508	31.85	22.32	17.86	15.06	13.98 (D)

NEW PRODUCTS



Perpendicular Double Sided Slim LED Illuminated Sign (ISSP16X2)

Light up your brand with bright and bold double sided illuminated sign. Includes impressive full color high resolution imprint. Acrylic illuminated sign can be contour cut to any shape that fits within the outside dimensions. We can quote any size or shape required for your specific needs. LED illumination is powered by UL listed power supply with integrated on/off switch. Perpendicular wall mounting bracket included. Made in the U.S.A. Concept through production completed domestically in days without the hassle and time of overseas production.

Product Dimensions: 18.7" x 1" x 16" | Image Area: Up to 14.5" | Sides: 2 | Full Color | Set-up: \$195 (G)

Item	10+	50+	100+	250+	500+
ISSP16X2	327.14	286.90	263.67	245.06	235.20 (D)



Solid Wood A-frame Sidewalk Sign (AFSW2439CB)

Solid wood a-frame is painted to match your brand. High resolution graphic is direct printed on two-sided chalkboard panel. Chalk panel is attached with wind proof screw hooks. Chalk is included. Made in the USA.

Product Dimensions: 23.5" x 39" | Image Area: 19.5" x 34" | Sides: 2 | Full Color | Set-up: \$85 (G)

Item	10+	50+	100+	250+	500+
AFSW2439CB	163.00	140.02	127.35	113.57	108.86 (D)



One Piece Bottle Glorifier 3 holes (BG1P3)

Self illuminated bottle glorifier is constructed of fluorescent acrylic that uses ambient light to illuminate the edges without the need of electricity. Formed from one solid piece of acrylic without the need for fasteners. Made in the USA.

Product Dimensions: 13" x 9.875" x 3.5" | Image Area: 9.875" x 1.625" & 11.75" x 1.625" | Sides: 1 | Full Color | Set-up: \$85 (G)

Item	10+	50+	100+	250+	500+
BG1P3	51.00	43.71	37.62	34.08	31.62 (D)



Door Insert Sign (DIS1424)

Front door message holder display holds two 8.5" x 11" inserts to display store hours or a variety of other information. Includes includes permanent branding in 1-4C. Ready to mount inside of glass doors with four suction cups. Made in the USA.

Product Dimensions: 23.5" x 14.24" | Image Area: 23.5" x 14.24" | Sides: 2 | Full Color | Set-up: \$195 (G)

Item	10+	50+	100+	250+	500+
DIS1424	93.74	82.72	72.34	66.22	61.65 (D)



Illuminated Three Bottle Glorifier (IBG0616F)

LED illuminated bottle glorifier. Great for restaurants or bars. Solid wood base made of renewable Poplar and painted with eco-friendly water based paint. Holds up to three bottles. Illuminates by internal LEDs. Includes UL listed power supply with integrated on / off toggle switch. Made in the USA

Product Dimensions: 16" x 6" x 5.5" | Image Area: 16" x 5.5" | Sides: 2 | 2 Color | Set-up: \$195 (G)

Item	10+	50+	100+	250+	500+
IBG0616F	110.91	91.74	81.69	74.45	70.97 (D)



Double Sided Slim LED Illuminated Sign 12" x 36" (ISS1236X2)

Light up your brand with bright and bold double sided illuminated sign. Includes impressive full color high resolution imprint. Acrylic illuminated sign can be contour cut to any shape that fits within the outside dimensions. We can quote any size or shape required for your specific needs. Raised elements provide dimension that make your brand pop. LED illumination is powered by UL listed power supply with integrated on/off switch. Ready to overhead mount with included jack chain and S-hooks. Made in the U.S.A. Concept through production completed domestically in days without the hassle and time of overseas production.

Product Dimensions: 36" x 12" x 1" | Image Area: 35" x 11" | Sides: 2 | Full Color | Set-up: \$195 (G)

Item	10+	50+	100+	250+	500+
ISS1236X2	317.11	278.14	255.65	237.60	228.05 (E)



SIGNS

SPECIALTIES

CLOCKS

MIRRORS

SPECIALTY CLOCKS

ILLUMINATED CLOCKS

Quality construction for indoor/outdoor use. Can display from -40 to 120 degrees Fahrenheit. All thermometers come packaged in white gift box. Individual shipping boxes are available.



18" Thermometer (1800T)

Constructed with glass lens and plastic case. Includes full color high resolution imprint. Can be packaged in individual shipping box for additional \$3.50 (G).

Diameter: 18" | Depth: 1.87" | Case Color: Silver | Image Area: 15.5" diameter | Sides: 1 | Full Color
Set-up: \$85 (G) | Individual Shipping Box: 20" x 4.25" x 20" | Product Weight: 4 lbs.

Item	10+	50+	100+	250+	500+	
1800T	70.65	66.32	56.72	54.83	53.29	(D)



Depth: 1.87 in.



16" Thermometer (1600T)

Constructed with glass lens and chrome plated plastic case. Includes full color high resolution imprint. Can be packaged in individual shipping box for additional \$3.50 (G).

Diameter: 16" | Depth: 2" | Case Color: Chrome | Image Area: 12.4" diameter | Sides: 1 | Full Color
Set-up: \$85 (G) | Individual Shipping Box: 18" x 18" x 4.25" | Product Weight: 3 lbs.

Item	10+	50+	100+	250+	500+	
1600T	61.51	57.63	49.49	47.88	46.58	(D)



Depth: 2 in.



Triple Function Clock (1932)

Multifunctional clock displays time, temperature, and humidity. Constructed with glass lens and plastic case. Includes full color high resolution imprint. Can be packaged in individual shipping box for additional \$3.00 (G).

Dimensions: 13.75" x 10.75" x 1.5" | Case Color: Silver | Image Area: 8.3" diameter | Sides: 1 | Full Color
Set-up: \$85 (G) | Individual Shipping Box: 16" x 15" x 3" | Product Weight: 2 lbs.

Item	10+	50+	100+	250+	500+	
1932	43.28	39.83	36.83	34.85	32.89	(D)



Depth: 1.5 in.



14" Thermometer (1499T)

Constructed with acrylic lens and plastic case. Includes full color high resolution imprint. Can be packaged in individual shipping box for additional \$3.00 (G).

Diameter: 14" | Depth: 2.62" | Case Color: Black | Image Area: 12.4" diameter | Sides: 1 | Full Color
Set-up: \$85 (G) | Individual Shipping Box: 16" x 15" x 3" | Product Weight: 2.1 lbs.

Item	10+	50+	100+	250+	500+	
1499T	48.95	45.71	39.43	38.14	37.14	(D)



Depth: 2.62 in.

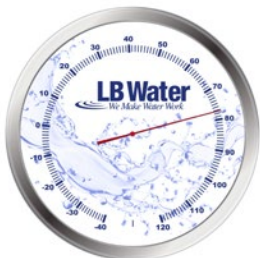

14" Metal Case Thermometer (1425T)

Constructed with glass lens and brushed nickel case. Includes full color high resolution imprint. Can be packaged in individual shipping box for additional \$3.00 (G).

Diameter: 14" | Depth: 2" | Case Color: Brushed Nickel | Image Area: 12.5" diameter | Sides: 1 | Full Color
Set-up: \$85 (G) | Individual Shipping Box: 18" x 18" x 4.25" | Product Weight: 3 lbs.

Item	10+	50+	100+	250+	500+	
1425T	76.62	72.45	68.31	65.51	62.37	(D)



Depth: 2 in.



14" Thermometer/Hygrometer (1499HT)

Quality construction for indoor/outdoor use. Can display from -40 to 120 degrees Fahrenheit as well as humidity. All thermometers/hygrometers come packaged in white gift box. Constructed with acrylic lens and plastic case. Includes full color high resolution imprint. Can be packaged in individual shipping box for additional \$3.00 (G).

Diameter: 14" | Depth: 2.6" | Case Color: Black/Red/White | Image Area: 12.4" diameter | Sides: 1 | Full Color |
Set-up: \$160 (G) | Individual Shipping Box: 16" x 15" x 3" | Product Weight: 2.1 lbs.

Item	100+	250+	500+	
1499HT	66.94	48.35	36.14	(D)



Depth: 2.6 in.

SIGNS

SPECIALTIES

CLOCKS

MIRRORS

SPECIALTY CLOCKS

ILLUMINATED CLOCKS

WALL CLOCKS

Promote your brand 24/7. Customize your clock by choosing from various sizes, cases, and colors. All clocks include a full color high resolution imprint. Great for restaurants, bars, banks, hotels, schools, dealerships, offices, and retail. Clocks come packaged in white gift box. Individual shipping boxes are available. Battery powered clock movement.



11.5" Clock (1878S)

Constructed with glass lens and plastic case. Includes full color high resolution imprint. Can be packaged in individual shipping box for additional \$3.00 (G).

Diameter: 11.5" | Depth: 1.62" | Case Color: Silver | Image Area: 10.75" diameter | Sides: 1 Full Color | Set-up: \$85 (G) | Individual Shipping Box: 16" x 15" x 3" | Product Weight: 2 lbs.

Item	10+	50+	100+	250+	500+	
1878S	36.77	33.69	27.85	26.66	25.71	(D)



Depth: 1.62 in.



14" Chrome Plated Clock (1114E)

Constructed with glass lens and chrome plated plastic case. Includes full color high resolution imprint. Can be packaged in individual shipping box for additional \$3.00 (G).

Diameter: 14" | Depth: 2" | Case Color: Chrome | Image Area: 10.25" diameter | Sides: 1 Full Color | Set-up: \$85 (G) | Individual Shipping Box: 16" x 15" x 3" | Product Weight: 2.5 lbs.

Item	10+	50+	100+	250+	500+	
1114E	45.83	41.95	34.72	33.20	32.03	(D)



Depth: 2 in.



14" Metal Case Clock (1425)

Constructed with glass lens and brushed nickel case. Includes full color high resolution imprint. Can be packaged in individual shipping box for additional \$3.00 (G).

Diameter: 14" | Depth: 2" | Case Color: Brushed Nickel | Image Area: 12.5" diameter | Sides: 1 | Full Color | Set-up: \$85 (G) | Individual Shipping Box: 18" x 18" x 4.25" | Product Weight: 3 lbs.

Item	10+	50+	100+	250+	500+	
1425	63.71	59.82	56.00	53.35	50.46	(D)



Depth: 2 in.



14" Clock (1499)

Constructed with acrylic lens and plastic case. Includes full color high resolution imprint. Can be packaged in individual shipping box for additional \$3.00 (G).

Diameter: 14" | Depth: 2.62" | Case Color: Black | Image Area: 12.4" diameter | Sides: 1 | Full Color | Set-up: \$85 (G) | Individual Shipping Box: 16" x 15" x 3" | Product Weight: 2 lbs.

Item	10+	50+	100+	250+	500+	
1499	44.48	40.85	33.83	32.38	31.31	(D)



Depth: 2.62 in.

SIGNS
SPECIALTIES
CLOCKS
MIRRORS
SPECIALTY CLOCKS
ILLUMINATED CLOCKS

Promote your brand 24/7. Customize your clock by choosing from various sizes, cases, and colors. All clocks include a full color high resolution imprint. Great for restaurants, bars, banks, hotels, schools, dealerships, offices, and retail. Clocks come packaged in white gift box. Individual shipping boxes are available. Battery powered clock movement.

SIGNS

SPECIALTIES

CLOCKS

MIRRORS

SPECIALTY CLOCKS

ILLUMINATED CLOCKS



16" Chrome Plated Clock (1600E)

Constructed with glass lens and chrome plated plastic case. Includes full color high resolution imprint. Can be packaged in individual shipping box for additional \$3.50 (G).

Diameter: 16" | Depth: 2" | Case Color: Chrome | Image Area: 12.4" diameter | Sides: 1 Full Color | Set-up: \$85 (G) | Individual Shipping Box: 18" x 18" x 4.25" | Product Weight: 3 lbs.

Item	10+	50+	100+	250+	500+	
1600E	58.31	53.95	44.91	43.09	41.65	(D)



Depth: 2 in.



18" Clock (1800S)

Constructed with glass lens and plastic case. Includes full color high resolution imprint. Can be packaged in individual shipping box for additional \$3.50 (G).

Diameter: 18" | Depth: 1.87" | Case Color: Silver | Image Area: 15.5" diameter | Sides: 1 Full Color | Set-up: \$85 (G) | Individual Shipping Box: 20" x 4.25" x 20" | Product Weight: 5 lbs.

Item	10+	50+	100+	250+	500+	
1800S	66.60	62.03	51.74	49.78	48.11	(D)



Depth: 1.87 in.



22" Jumbo Clock (2200)

Constructed with glass lens and heavy-duty plastic case. Includes full color high resolution imprint. Clock comes packaged in an individual shipping box.

Diameter: 22" | Depth: 2.75" | Case Color: Black, Red or Blue | Image Area: 16.25" diameter | Sides: 1 | Full Color | Set-up: \$85 (G) | Shipping Box: 24" x 4.25" x 24" | Shipping Weight: 9.6 lbs.

Item	10+	50+	100+	250+	500+	
2200	117.83	110.75	103.57	98.82	93.45	(D)

22" Neon Clock (2200N)

High quality clocks are complemented with bright neon lighting showcasing your brand. Includes full color high resolution imprint. Movement is battery powered and neon is powered by UL listed power supply with integrated on/off switch. Constructed with glass lens and heavy-duty plastic case. Clock comes packaged in an individual shipping box.

Diameter: 22" | Depth: 2.75" | Case Color: Black, Red or Blue | Image Area: 15.5 diameter" | Sides: 1 | Full Color | Set-up: \$85 (G) | Shipping Box: 24" x 24" x 4.25" | Shipping Weight: 9.6 lbs.

Item	10+	50+	100+	250+	500+	
2200N	218.92	207.08	194.25	185.69	175.74	(D)

Backlit Illuminated Clock 22" Diameter (2200i)

Constructed with glass lens, heavy-duty plastic case and backlit acrylic dial. Includes full color high resolution imprint. LED illumination is powered by UL listed power supply with integrated on/off switch. Battery powered clock movement.

Diameter: 22" | Depth: 5" | Case Color: Black, Red or Blue | Image area: 16.25" Diameter | Sides: 1 | Full Color | Set-up: \$85 (G) | Shipping Box: 33" x 33" x 9.5" | Shipping Weight: 11.4 lbs.

Item	10+	25+	50+	100+	250+	
2200i	243.39	224.80	214.56	192.37	184.26	(E)

CUSTOM SHAPE ACRYLIC CLOCKS

We will make your brand stand out by designing a unique custom shape acrylic clock. Our offering includes either wall hung or desktop options. Clocks are second surface printed on 3mm thick acrylic providing depth and enhancing the image.



Custom Shape Acrylic Clock 12" x 12" (ACRC1212)

Product Dimensions: Up to 11.75" x 11.75" x 1" | Image Area: Up to 11.75" x 11.75" | Sides: 1 Full Color | Set-up: \$195 (G) | Shipping Box: 12.3" x 12.3" x 2" | Shipping Weight: .7 lbs.

Custom Shape Acrylic Clock 12" x 16" (ACRC1216)

Product Dimensions: Up to 11.75" x 16" x 1" | Image Area: Up to 11.75" x 16" | Sides: 1 Full Color | Set-up: \$195 (G) | Shipping Box: 14.2" x 20.2" x 4.6" | Shipping Weight: 1.3 lbs.

Custom Shape Acrylic Clock 18" x 24" (ACRC1824)

Product Dimensions: Up to 18" x 23.5" x 1" | Image Area: Up to 18" x 23.5" | Sides: 1 Full Color | Set-up: \$195 (G) | Shipping Box: 19.5" x 19.5" x 4" | Shipping Weight: 2.2 lbs.

Custom Shape Acrylic Clock 24" x 24" (ACRC2424)

Product Dimensions: Up to 23.5" x 23.5" x 1" | Image Area: Up to 23.5" x 23.5" | Sides: 1 Full Color | Set-up: \$195 (G) | Shipping Box: 23.7" x 23.7" x 4" | Shipping Weight: 3.6 lbs.

Item	10+	50+	100+	250+	500+	
ACRC1212	63.23	54.26	49.12	45.57	43.89	(D)
ACRC1216	72.78	62.82	57.06	53.05	51.06	(D)
ACRC1824	112.22	97.94	89.55	83.42	80.26	(D)
ACRC2424	159.06	139.98	128.60	120.00	115.51	(D)

CUSTOM SHAPE DIGITAL CLOCKS

We will make your brand stand out by designing a unique custom shape digital clock. Can be contour cut to any shape that fits within the outside dimensions. Four Digit LED clock is powered by plugging into standard wall outlet. Red digits are 1.8" tall.



Digital Acrylic Clock 12" x 12" (ACRD1212)

Product Dimensions: Up to 11.75" x 11.75" x 1" | Image Area: Up to 11.75" x 11.75" | Sides: 1 Full Color | Set-up: \$195 (G) | Shipping Box: 12.3" x 12.3" x 2" | Shipping Weight: 1.7 lbs.

Digital Acrylic Clock 12" x 16" (ACRD1216)

Product Dimensions: Up to 11.75" x 16" x 1" | Image Area: Up to 11.75" x 16" | Sides: 1 Full Color | Set-up: \$195 (G) | Shipping Box: 14.2" x 20.2" x 4.6" | Shipping Weight: 2.3 lbs.

Digital Acrylic Clock 18" x 24" (ACRD1824)

Product Dimensions: Up to 18" x 23.5" x 1" | Image Area: Up to 18" x 23.5" | Sides: 1 Full Color | Set-up: \$195 (G) | Shipping Box: 19.5" x 19.5" x 4" | Shipping Weight: 3.2 lbs.

Digital Acrylic Clock 24" x 24" (ACRD2424)

Product Dimensions: Up to 23.5" x 23.5" x 1" | Image Area: Up to 23.5" x 23.5" | Sides: 1 Full Color | Set-up: \$195 (G) | Shipping Box: 23.7" x 23.7" x 4" | Shipping Weight: 4.6 lbs.

Item	10+	50+	100+	250+	500+	
ACRD1212	167.17	147.80	135.48	127.62	123.57	(D)
ACRD1216	179.69	159.11	146.05	137.46	133.00	(D)
ACRD1824	187.82	166.72	153.46	144.31	139.43	(D)
ACRD2424	245.23	218.29	201.38	189.14	182.58	(D)

Digital Wood Clock 12" x 16" (WSD1216)

Product Dimensions: Up to 11.75" x 16" x 2" | Image Area: Up to 11.75" x 16" | Sides: 1 Full Color | Set-up: \$185 (G) | Shipping Box: 14.2" x 20.2" x 4.6" | Shipping Weight: 2.5 lbs.

Digital Wood Clock 18" x 24" (WSD1824)

Product Dimensions: Up to 18" x 23.5" x 2" | Image Area: Up to 18" x 23.5" | Sides: 1 Full Color | Set-up: \$185 (G) | Shipping Box: 29.75" x 18.125" x 1" | Shipping Weight: 6.0 lbs.

Digital Wood Clock 24" x 36" (WSD2436)

Product Dimensions: Up to 23.5" x 35" x 2" | Image Area: Up to 23.5" x 35" | Sides: 1 Full Color | Set-up: \$185 (G) | Shipping Box: 26" x 38" x 1" | Shipping Weight: 13.4 lbs.

Item	10+	50+	100+	250+	500+	
WSD1216	151.85	126.98	113.72	104.03	99.32	(D)
WSD1824	157.22	140.17	128.34	121.86	118.55	(D)
WSD2436	223.58	194.49	177.20	165.43	159.45	(D)



Mirrors are an excellent way to draw attention to your brand. We offer wood framed glass mirrors, custom shape 3mm acrylic mirrors, innovative illuminated mirrors, and solid ash frame weathered/rustic mirrors. All of our high-quality mirrors include a full color high resolution imprint at no additional charge.



Mirror 18" x 24" (MR1824)

Product Dimensions: 19" x 24" x .68" | Image Area: 16" x 21" | Sides: 1 | Full Color | Set-up: \$85 (G)
Shipping Box: 30" x 22" x 2.25" | Shipping Weight: 9.7 lbs.

Mirror 24" x 24" (MR2424)

Product Dimensions: 24" x 24" x .68" | Image Area: 21" x 21" | Sides: 1 | Full Color | Set-up: \$85 (G)
Shipping Box: 38.25" x 27" x 2.25" | Shipping Weight: 12 lbs.

Mirror 24" x 36" (MR2436)

Product Dimensions: 24" x 36" x .68" | Image Area: 21" x 33" | Sides: 1 | Full Color | Set-up: \$85 (G)
Shipping Box: 39" x 28" x 5" | Shipping Weight: 17.2 lbs.

Item	5+	10+	25+	50+	100+	250+	500+
MR1824	236.94	187.77	158.35	133.25	119.83	109.89	104.92 (D)
MR2424	247.63	202.95	176.20	152.89	138.88	129.63	125.06 (D)
MR2436	287.55	241.60	202.38	177.08	161.52	151.22	145.95 (D)



Rustic Frame Mirror 18" x 24" (MR1824RF)

Product Dimensions: 19" x 24" x 1.13" | Image Area: 16" x 21" | Sides: 1 | Full Color
Set-up: \$85 (G) | Shipping Box: 30" x 22" x 2.25" | Shipping Weight: 9.7 lbs.

Rustic Frame Mirror 24" x 36" (MR2436RF)

Product Dimensions: 24" x 36" x 1.13" | Image Area: 21" x 33" | Sides: 1 | Full Color
Set-up: \$85 (G) | Shipping Box: 39" x 28" x 5" | Shipping Weight: 18.2 lbs.

Item	10+	50+	100+	250+	500+
MR1824RF	160.14	136.63	123.38	113.63	108.15 (D)
MR2436RF	212.42	187.74	171.65	161.08	154.86 (D)

*Custom printed frame available upon request.



Custom Shape Acrylic Mirror 18" x 24" (MRA1824)

Product Dimensions: Up to 18" x 23.5" x .125" | Image Area: Up to 18" x 23.5" | Sides: 1 | Full Color
Set-up: \$195 (G) | Shipping Box: 29.4" x 21.7" x 2.5" | Shipping Weight: 3.5 lbs.

Custom Shape Acrylic Mirror 24" x 24" (MRA2424)

Product Dimensions: Up to 23.5" x 23.5" x .125" | Image Area: Up to 23.5" x 23.5" | Sides: 1 | Full Color
Set-up: \$195 (G) | Shipping Box: 26.3" x 32" x .5" | Shipping Weight: 3.7 lbs.

Custom Shape Acrylic Mirror 24" x 36" (MRA2436)

Product Dimensions: Up to 23.5" x 36" x .125" | Image Area: Up to 23.5" x 36" | Sides: 1 | Full Color
Set-up: \$195 (G) | Shipping Box: 26" x 38" x .5" | Shipping Weight: 6.3 lbs.

Item	10+	50+	100+	250+	500+
MRA1824	139.31	114.83	102.03	92.85	88.49 (D)
MRA2424	169.28	141.92	127.29	116.55	111.31 (D)
MRA2436	238.49	203.85	184.89	170.35	163.06 (D)



Illuminated Mirror 18" x 24" (ILMR1824)

By highlighting high resolution graphics, our patented Illuminated Mirror makes your brand the focal point among any competitive advertising. Cost effective and long life LED illumination. UL listed power supply with integrated on/off switch.

Product Dimensions: 19" x 23" x 2.25" | Image Area: 16" x 21"
Sides: 1 | Full Color | Set-up: \$195 (G)
Shipping Box: 24" x 24" x 4" | Shipping Weight: 11 lbs.

Item	10+	50+	100+	250+	500+
ILMR1824	188.78	167.54	153.08	145.06	141.09 (D)

SIGNS

SPECIALTIES

CLOCKS

MIRRORS

SPECIALTY CLOCKS

ILLUMINATED CLOCKS

PENDULUM AND PLASTIC CLOCKS

Sophisticated pendulum clocks constructed with a solid wood frame, brass pendulum, and glass lens. Price includes full color printing direct on the glass lens and on the background (dial panel). Solid maple wood frame available in black, red mahogany, medium brown or light autumn.



Solid Wood Framed Clock 12" x 20" (9518)

Product Dimensions: 12" x 20" x 3" | Dial Image Area: 7" x 7" | Glass Image Area: 7" x 6.75"
Sides: 1 | Full Color | Set-up: \$120 (G)
Shipping Box: 20.5" x 14.4" x 4.75" | Shipping Weight: 7.8 lbs.

Item	25+	50+	100+	250+	500+	
9518	148.15	130.38	117.60	109.80	103.03	(D)



Solid Wood Framed Clock 13" x 24" (95205)

Product Dimensions: 14" x 25" x 3" | Dial Image Area: 7" x 7" | Glass Image Area: 7" x 9.75"
Sides: 1 | Full Color | Set-up: \$120 (G)
Shipping Box: 26.5" x 13.5" x 3.25" | Shipping Weight: 8.6 lbs.

Item	25+	50+	100+	250+	500+	
95205	153.51	135.28	122.22	114.11	107.15	(D)



Molded Acrylic Bottle Cap Clock 18" (ABC18CL)

Clock dials are direct digital printed or can be applied with vinyl overlay on high impact thermoformed ABS. Clock movement is powered by one AA battery. Digital Clock can be substituted in place of analog clock for an additional \$52.75 (D) per unit.

Product Dimensions: Up to 18" Diameter | Image Area: Up to 14" Diameter | Sides: 1 | Full Color Set-up: \$195 (G) | Shipping Box: 19.5" x 19.5" x 4" | Shipping Weight: 2.2 lbs.

Item	10+	50+	100+	250+	500+	
ABC18CL	112.18	97.94	89.82	83.35	79.95	(D)

OPEN FACE WOOD CLOCKS

Real wood framed clocks at an affordable price. Solid maple wood frame available in black, red mahogany, medium brown or light autumn. Includes full color high resolution imprint. Battery powered movement.



Open Face Wood Clock 14" x 14" (1414)

Product Dimensions: 14" x 14" x 2.25" | Image Area: 11.5" x 11.5" Sides: 1 | Full Color | Set-up: \$85 (G)
Shipping Box: 15.5" x 14.75" x 3" | Shipping Weight: 4.5 lbs.

Open Face Wood Clock 18" x 18" (1818)

Product Dimensions: 18" x 18" x 2.25" | Image Area: 15.9" x 15.9" Sides: 1 | Full Color | Set-up: \$85 (G)
Shipping Box: 24" x 24" x 4.25" | Shipping Weight: 7 lbs.

Open Face Wood Clock 26" x 26" (2626)

Product Dimensions: 26" x 26" x 2.25" | Image Area: 23.25" x 23.25" Sides: 1 | Full Color | Set-up: \$85 (G)
Shipping Box: 27.25" x 38.25" x 4.25" | Shipping Weight: 14 lbs.

Item	10+	50+	100+	250+	500+	
1414	94.02	88.29	82.55	78.74	74.51	(D)
1818	108.11	101.82	95.34	91.03	86.14	(D)
2626	145.17	137.31	128.77	123.15	116.55	(D)



Open Face Wood Clock 22" x 12" (1222)

Product Dimensions: 22" x 12" x 2.25" | Image Area: 19.8" x 9.7"
Sides: 1 | Full Color | Set-up: \$85 (G)
Shipping Box: 24.5" x 15.75" x 4.25" | Shipping Weight: 5.7 lbs.

Item	10+	50+	100+	250+	500+	
1222	105.29	99.08	92.65	88.48	83.66	(D)



SIGNS

SPECIALTIES

CLOCKS

MIRRORS

SPECIALTY CLOCKS

ILLUMINATED CLOCKS

WOOD FRAMED CLOCKS

Classic high quality clocks constructed with a solid wood frame and glass lens. Price includes full color printing direct on the glass lens and on the background (dial panel). Solid maple wood frame available in black, red mahogany, medium brown or light autumn. Battery powered movement. Chalkboard option for our 1016 clock.



Solid Wood Framed Clock 12" x 18" (1016) 🌱

Product Dimensions: 12" x 18" x 2.5" | Glass Size: 16" x 10"
 Sides: 1 | Full Color | Set-up: \$120 (G)
 Shipping Box: 20.5" x 14.4" x 4.75" | Shipping Weight: 5.5 lbs.

Item	10+	50+	100+	250+	500+	
1016	114.95	107.12	99.72	94.94	89.82	(D)
1016CB	117.88	109.34	101.23	96.54	91.52	(D)

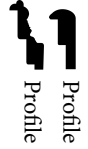

Solid Wood Framed Clock 19" x 27" (2416) 🌱

Acrylic lens.
 Product Dimensions: 19" x 27" x 2.5" | Acrylic Lens Size: 15.5" x 23.5"
 Sides: 1 | Full Color | Set-up: \$120 (G)
 Shipping Box: 29.5" x 21.5" x 2.5" | Shipping Weight: 7.9 lbs.

Item	10+	50+	100+	250+	500+	
2416	152.00	143.03	133.77	127.78	120.89	(D)

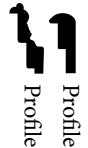

Solid Wood Framed Clock 11.5" x 22.5" (1020) 🌱

Product Dimensions: 11.5" x 22.5" x 2.5" | Glass Size: 9.5" x 20.5"
 Sides: 1 | Full Color | Set-up: \$120 (G)
 Shipping Box: 26.5" x 13.5" x 3.25" | Shipping Weight: 7.8 lbs.

Item	10+	50+	100+	250+	500+	
1020	132.46	123.74	115.32	109.85	103.86	(D)

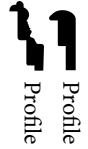

Solid Wood Framed Clock 10" x 14.5" (7512) 🌱

Product Dimensions: 10" x 14.5" x 2.5" | Glass Size: 7.5" x 12"
 Sides: 1 | Full Color | Set-up: \$120 (G)
 Shipping Box: 12" x 16.25" x 4.5" | Shipping Weight: 4.5 lbs.

Item	10+	50+	100+	250+	500+	
7512	96.18	89.20	82.92	78.78	74.40	(D)

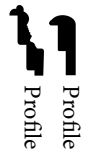

Solid Wood Framed Clock 15" x 15" (1212) 🌱

Product Dimensions: 15" x 15" x 2.5" | Glass Size: 12" x 12"
 Sides: 1 | Full Color | Set-up: \$120 (G)
 Shipping Box: 15.5" x 14.75" x 3" | Shipping Weight: 5.1 lbs.

Item	10+	50+	100+	250+	500+	
1212	122.15	113.83	105.92	100.80	95.31	(D)



FRAME STAIN OPTIONS



Black



Red Mahogany



Medium Brown



Light Autumn

**CUSTOM PAINT
 COLOR FRAME
 (PANTONE MATCH)**

**Available upon request.*

SIGNS

SPECIALTIES

CLOCKS

MIRRORS

SPECIALTY
 CLOCKS

ILLUMINATED
 CLOCKS

NEON CLOCKS

High quality clocks are complemented with bright neon lighting showcasing your brand. Movement is battery powered and neon is powered by UL listed power supply with integrated on/off switch.



16" Chrome Steel Neon Clock (1625N)

16" Chrome Steel Neon Clock w/ Custom Color Lens (1625NPL)

High quality clocks are complemented with bright neon lighting showcasing your brand. (1625NPL) Lens has a printed border on lens to add color to illumination of the neon. Movement is battery powered and neon is powered by UL listed power supply with integrated on/off switch. Real chrome steel case and glass lens. Clock comes packaged in a white gift box. Can be packaged in an individual shipping box for additional \$3.50 (G).

Diameter: 16" | Depth: 3" | Image Area: 11.125" diameter | Sides: 1 | Full Color | Set-up: \$85 (G)
Shipping Box: 20" x 20" x 6.125" | Product Weight: 5.8 lbs.

Item	10+	50+	100+	250+	500+	
1625N	130.58	123.20	115.49	110.34	104.38	(D)
1625NPL	135.97	128.58	120.88	115.72	109.77	(D)



15" Chrome Plated Plastic Faux Neon Clock (CU1525L)

Promote your brand 24/7. Great for restaurants, bars, banks, hotels, schools, dealerships, offices, and retail. Clocks come packaged in white gift box. Individual shipping boxes are available. Battery powered clock movement. Constructed with glass lens and chrome plated plastic case and Faux Neon LED illuminated tube. Replicates the look of real Neon without the high cost. Includes full color high resolution imprint.

Diameter: 15" | Depth: 3" | Image Area: 9.5" diameter | Sides: 1 | Full Color | Set-up: \$85 (G)

Item	10+	50+	100+	250+	500+	
CU1525NL	77.18	71.14	65.57	58.62	54.43	(D)

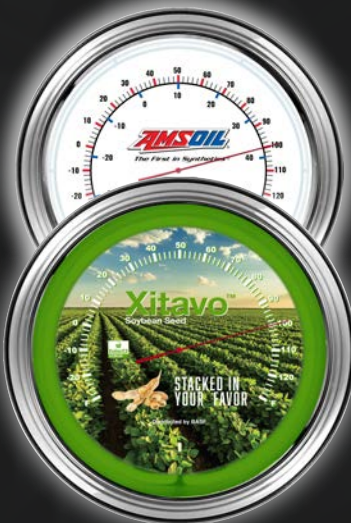

16" Chrome Steel Neon Thermometer (1625NT)

16" Chrome Steel Neon Thermometer w/ Custom Color Lens (1625NPLT)

High quality Thermometers are complemented with bright neon lighting showcasing your brand. Quality construction for indoor use. Can display from -40 to 120 degrees Fahrenheit. The (1625NPL) has a printed border on lens to add color to illumination of the neon. Neon is powered by UL listed power supply with integrated on/off switch. Real chrome steel case and glass lens. Thermometer comes packaged in a white gift box. Can be packaged in an individual shipping box for additional \$3.50 (G).

Diameter: 16" | Depth: 3" | Image Area: 11.125" diameter | Sides: 1 | Full Color | Set-up: \$85 (G)
Shipping Box: 20" x 20" x 6.125" | Product Weight: 5.8 lbs.

Item	10+	50+	100+	250+	500+	
1625NT	141.22	132.88	124.82	119.98	113.77	(D)
1625NPLT	147.43	139.11	131.03	126.20	119.98	(D)

SIGNS

SPECIALTIES

CLOCKS

MIRRORS

SPECIALTY CLOCKS

ILLUMINATED CLOCKS

By highlighting high resolution graphics, illuminated products draw attention to your brand. Cost effective and long life LED illumination. Includes full color high resolution imprint.



Backlit Illuminated Clock 12" x 18" (1117i)

Solid maple wood frame available in black, red mahogany, medium brown or light autumn. Backlit acrylic dial. Glass lens with full color border. LED illumination is powered by UL listed power supply with integrated on/off switch. Battery powered clock movement.

Product Dimensions: 12.25" x 18.125" x 3.5" | Imprint area: 11.25" x 17.125" | Sides: 1 | Full Color | Set-up: \$120 (G)
Shipping Box: 13.25" x 21" x 6" | Shipping Weight: 7.5 lbs.

Item	10+	25+	50+	100+	250+	
1117i	205.73	190.01	181.34	162.57	155.71	(E)



Backlit Illuminated Clock 30" x 30" (3024i)

Solid maple wood frame stained in black. Backlit acrylic dial. Glass lens with full color border. Clock movement and illumination powered by plugging into standard wall outlet.

Product Dimensions: 30" x 30" x 7" | Image area: 27" x 27" | Sides: 1 | Full Color | Set-up: \$120 (G)
Shipping Box: 33" x 33" x 9.5" | Shipping Weight: 24.8 lbs.

Item	1+	5+	10+	25+	50+	100+	250+	
3024i	745.21	688.41	656.94	588.94	564.06	552.30	541.47	(E)



Backlit Illuminated Clock 22" Diameter (2200i)

Constructed with glass lens, heavy-duty plastic case and backlit acrylic dial. LED illumination is powered by UL listed power supply with integrated on/off switch. Battery powered clock movement.

Diameter: 22" | Depth: 5" | Image area: 16.25" Diameter | Sides: 1 | Full Color | Set-up: \$120 (G)
Shipping Box: 33" x 33" x 9.5" | Shipping Weight: 11.4 lbs.

Item	10+	25+	50+	100+	250+	
2200i	243.39	224.80	214.56	192.37	184.26	(E)



Backlit Illuminated Clock 17" x 17" (1688i)

Solid maple wood frame available in black, red mahogany, medium brown or light autumn. Backlit acrylic dial. Glass lens with full color border. LED illumination is powered by UL listed power supply with integrated on/off switch. Battery powered clock movement.

Product Dimensions: 17" x 17" x 3.5" | Imprint area: 14.375" x 14.375" | Sides: 1 | Full Color | Set-up: \$120 (G)
Shipping Box: 20" x 20" x 4.25" | Shipping Weight: 10 lbs.

Item	10+	25+	50+	100+	250+	500+	
1688i	221.17	204.30	194.97	174.80	167.41	163.97	(E)



Backlit Illuminated Clock 24" x 12" (2112i)

Solid maple wood frame available in black, red mahogany, medium brown or light autumn. Backlit acrylic dial. Glass lens with full color border. LED illumination is powered by UL listed power supply with integrated on/off switch. Battery powered clock movement.

Product Dimensions: 24" x 12" x 3.5" | Image area: 21.25" x 10.75" | Sides: 1 | Full Color | Set-up: \$120 (G)
Shipping Box: 28.25" x 13.25" x 4.25" | Shipping Weight: 11.6 lbs.

Item	10+	25+	50+	100+	250+	500+	
2112i	202.33	186.91	178.34	159.91	153.16	149.97	(E)

SIGNS

SPECIALTIES

CLOCKS

MIRRORS

SPECIALTY CLOCKS

ILLUMINATED CLOCKS

HANOVER

P R O D U C T S

MORE INFORMATION

- **Co-op Programs:** Available, call for details.
- **Phone Orders:** Must be confirmed by fax, mail or e-mail copy.
- **Pricing:** Special quotes will be given for orders that: exceed the maximum quantity; exceed the largest size shown in the catalog; items not shown in the catalog.
- **Returns:** Not accepted without prior factory approval.
- **Shipping:** F.O.B. our facility in Ohio. Unless a specified method of shipping is requested, we will use our judgment choosing the carrier. Generally, we use the most economical carrier.
- **Claims and Returns:** Claims must be made within 14 days of receipt of shipment.
- **Drop Shipment:** \$9.98 (C) for each destination shipment after the original shipment order.
- **Trademarks:** Manufacturer assumes that our clients are authorized to use the trademarks presented to us for reproduction.

We assume no liability in trademark or copyright disputes. The logos, designs and trademarks imprinted on items in this catalog have been reproduced as examples of the types of customizing available. They are not presented for resale and should not be constructed as product/brand name endorsements by or for the trademark owners.

We reserve the right to use all products in our advertising and displays unless otherwise notified in writing at the time of the order.

All prices are subject to change without prior notice. © 2026 Hanover Products.



In an ongoing effort to reduce our carbon footprint and impact on the environment, we've partnered with Ranpak Corp. to offer an eco-friendly, sustainable packaging option at no additional cost to our customers. This paper-based, environmentally-conscious packaging option replaces Styrofoam, expanding foam, bubble wrap, air pillows and poly bags to provide a zero single-use plastic packaging solution.

Join our earth-friendly efforts by requesting sustainable packing with your next order.

VERSION 59

PPAI# 236594

Sage# 27956

ASI# 59535